

# Hibiscus

TYPE 7

## 2 Bedroom Villa + Single Garage

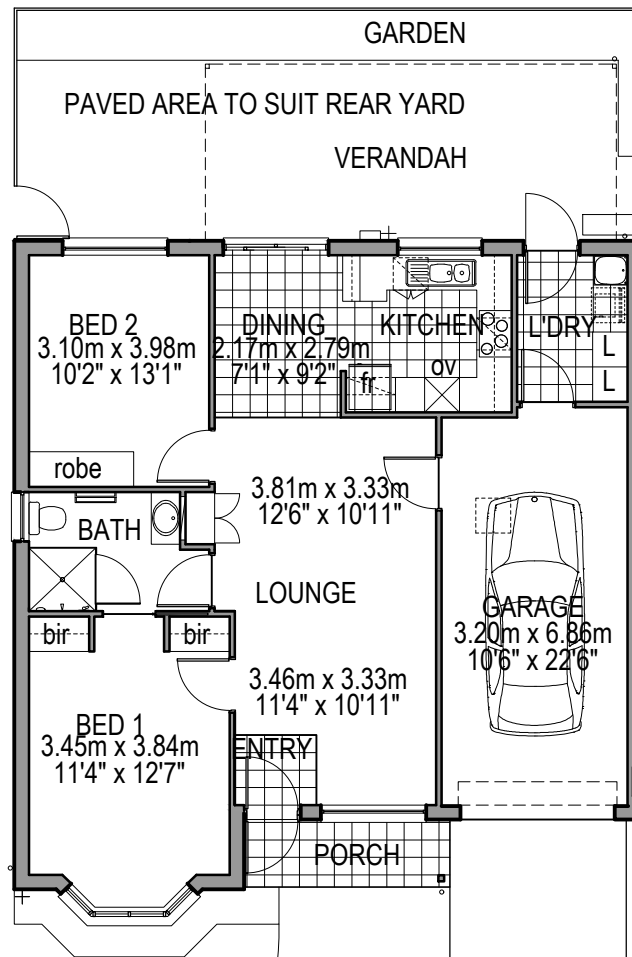

LIVING...	88.49m <sup>2</sup>	(9.52sq's)
GARAGE...	24.70m <sup>2</sup>	(2.65sq's)
PORCH...	4.10m <sup>2</sup>	(0.44sq's)
TOTAL...	117.29m <sup>2</sup>	(12.62sq's)

Disclaimer: These plans are indicative only & subject to alteration. Final plans by agreement between the client & the company.

  
**Angle Vale Gardens**  
RETIREMENT ESTATE

4 Fradd Road, Angle Vale, SA 5117 Ph. 08 8284 8801  
info@anglevalegardens.com.au www.anglevalegardens.com.au

# Villas

## Standard Finishes and Inclusions

### External Features

- Secure front gate entry with camera vision in villa
- Private rear yards
- Coloured concrete patterned paving to rear yard
- Rear yard ready for resident planting
- Outback verandah
- Lift Up Clothes line
- Colorbond Good Neighbour Fencing
- Gas Instant Hot Water Service
- Landscaped front garden
- Weatherproof GPO Powerpoint
- Security doors to front, rear and sliding glass door
- Automatic garage door

### Internal Features

- 3 telephone / communication points
- 2 television points
- Smoke detectors / alarm
- Linen cupboard
- Aluminium windows
- Tiled entry, porch and dining
- Garage entry to villa
- Provision for Foxtel and Broadband
- Reverse-cycle split air to Type 7
- Ceiling height 2550 (8'6") to Type 7
- Robe in Bed 2

### Kitchen

- Modern kitchen
- Stainless steel fan forced oven
- Ceramic cooktop and range hood, stainless steel finish
- Pantry
- Ceramic tiles
- 1.5 bowl sink with flip mixer tap
- Provision for future dishwasher
- Small bin in sink bench cupboard

### Bathrooms

- Exhaust fans / heat lamps
- Bathroom walls / floors tiled
- Pivot shower screens
- Mixer tap to shower and basin
- Wall tiles to 1.2 metres high Type 7

### Laundry

- Well sized laundry
- Storage cupboard
- Stainless steel tub
- Ceramic tiles