

Uniting The Garrison

Unit 57

Crn Spit Road & Punch Street, Mosman

1 Bedroom

Internal Area: m² approx.

External Area: m² approx.

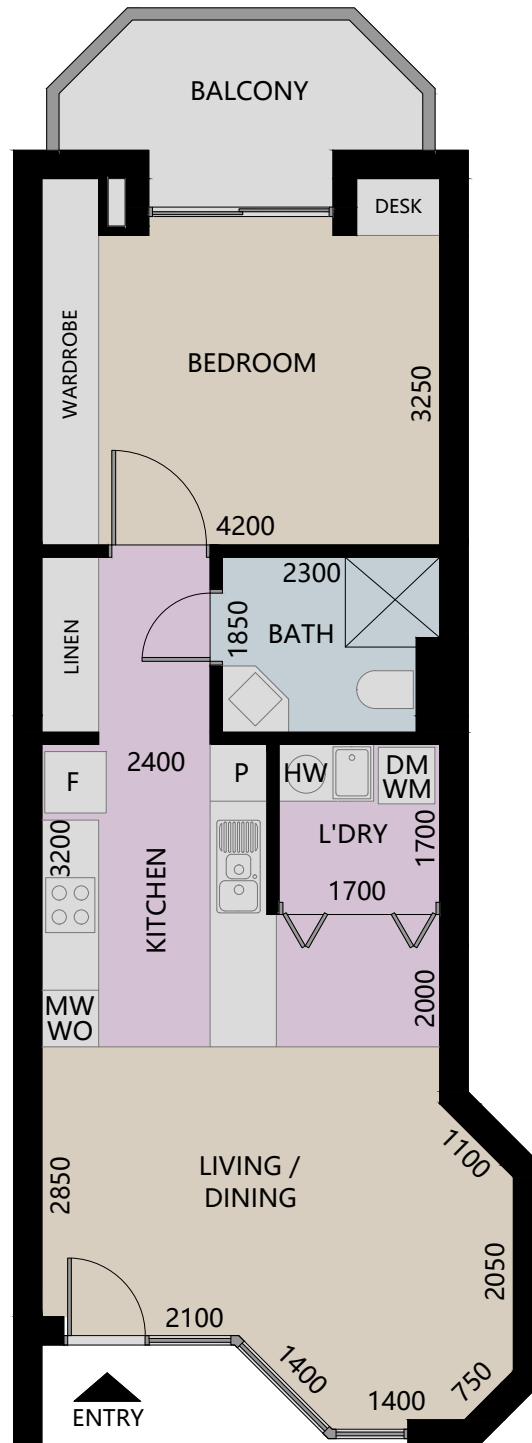
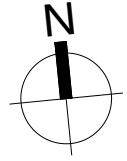

Please note these measurements are approximate only. The plan is intended as a rough guide for illustrative purposes. It is not warranted or guaranteed to be correct nor is it part of the sale or rental contract.

Uniting