



Revision: C
Date: 06/05/2025



Disclaimer: Legacy Property do not guarantee, warrant or represent that the information contained is correct. Any interested parties should make their own enquiries as to the accuracy of the information. We exclude all inferred or implied terms, conditions and warranties arising out of this document and any liability for loss or damage arising there from.

Photographs, facades, renders and other pictures displayed in this flyer are for illustrative purposes only and may show a facade, landscaping, fixtures, fittings or finishes that are not inclusive of this apartment. For a full list of inclusions, please contact a Sales consultant at The Works.

2518

THE WORKS

Corrimal

BUILDING 1.5 APARTMENT 3401

5 2 2

Size
Interior 127m²
External 23m²
Total 150m²
Aspect South

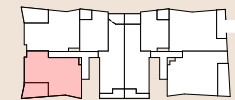

Display Centre
237 Princes Hwy, Corrimal NSW 2518

THEWORKSCORRIMAL.COM.AU
1800 827 005

