

Revision: C  
Date: 19/05/2025



**Disclaimer:** Legacy Property do not guarantee, warrant or represent that the information contained is correct. Any interested parties should make their own enquiries as to the accuracy of the information. We exclude all inferred or implied terms, conditions and warranties arising out of this document and any liability for loss or damage arising there from.

Photographs, facades, renders and other pictures displayed in this flyer are for illustrative purposes only and may show a facade, landscaping, fixtures, fittings or finishes that are not inclusive of this apartment. For a full list of inclusions, please contact a Sales consultant at The Works.

2518

# THE WORKS

Corrimal

## BUILDING 1.4 APARTMENT 4206

2 2 1

Size  
Interior 92m<sup>2</sup>  
External 17m<sup>2</sup>  
Total 109m<sup>2</sup>  
Aspect South-West

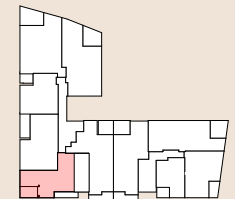

Display Centre  
237 Princes Hwy, Corrimal NSW 2518

THEWORKSCORRIMAL.COM.AU  
1800 827 005